

3/30/2020 4:09:14 PM
 \\p1561\proj\02\103\02-PermDOT12_SRO981-020\300_CADD\p1561\env\1\components\1\stream\impact\0981-020-FD002-INC2.dgn

DISTRICT	COUNTY	ROUTE	SECTION	SHEET
12-0	WESTMORELAND	0981	Q20	2 OF 156
MOUNT PLEASANT TOWNSHIP				
REVISION NUMBER	REVISIONS	DATE	BY	

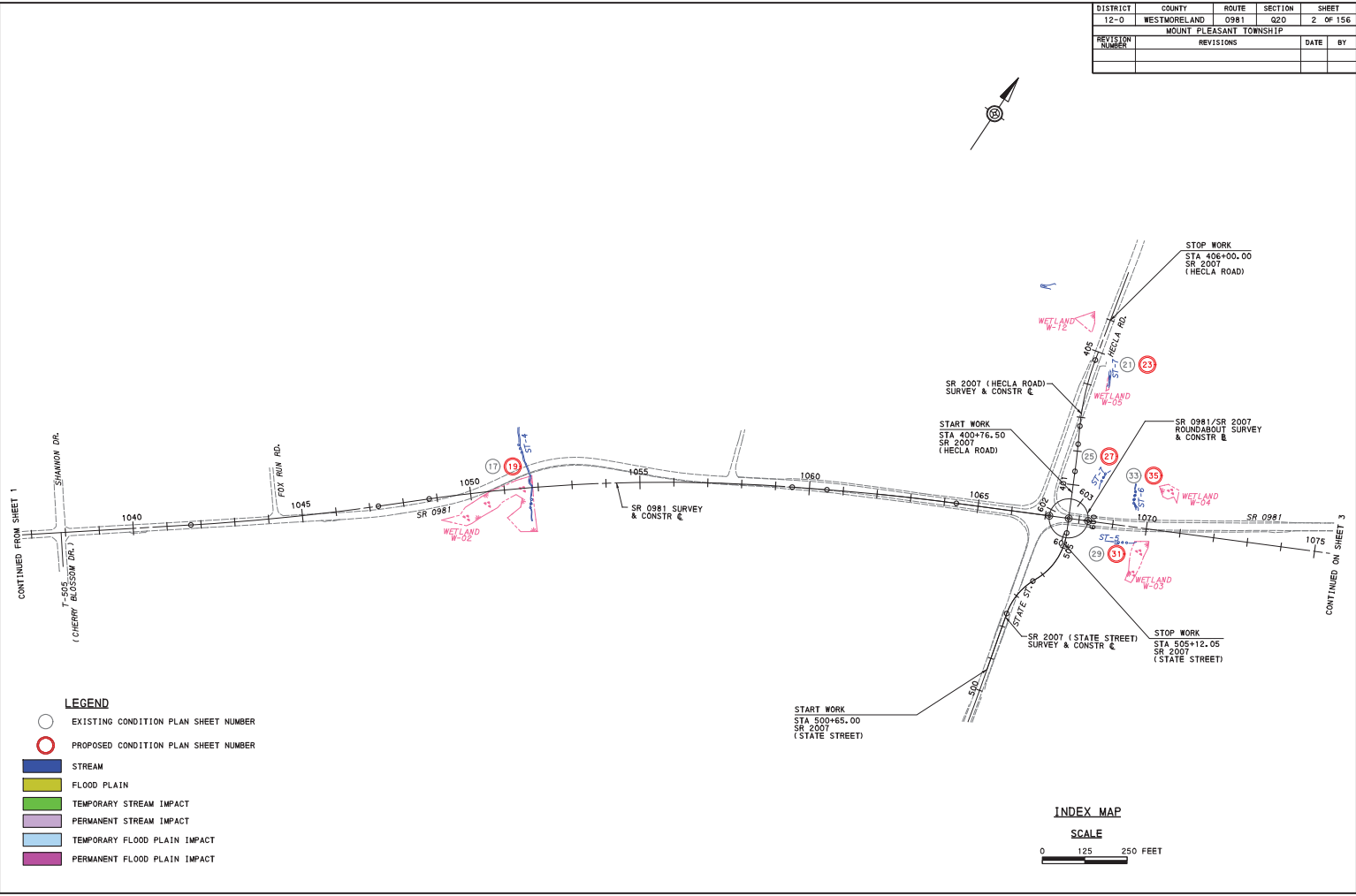

- LEGEND**
- EXISTING CONDITION PLAN SHEET NUMBER
 - PROPOSED CONDITION PLAN SHEET NUMBER
 - ▬ STREAM
 - ▭ FLOOD PLAIN
 - ▭ TEMPORARY STREAM IMPACT
 - ▭ PERMANENT STREAM IMPACT
 - ▭ TEMPORARY FLOOD PLAIN IMPACT
 - ▭ PERMANENT FLOOD PLAIN IMPACT

START WORK
 STA 500+65.00
 SR 2007
 (STATE STREET)

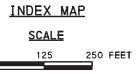

CONTINUED ON SHEET 3

CONTINUED FROM SHEET 1

3/30/2020 4:09:15 PM
 \\p051\proj\envs\13193-02-Permit12_SRO981-020\300_CADD\p\loc_Ser\Env\Incoment\13193-02-Permit12_SRO981-020-FD004-1\INCA.dgn

DISTRICT	COUNTY	ROUTE	SECTION	SHEET
12-0	WESTMORELAND	0981	Q20	4 OF 156
MOUNT PLEASANT TOWNSHIP				
REVISION NUMBER	REVISIONS	DATE	BY	

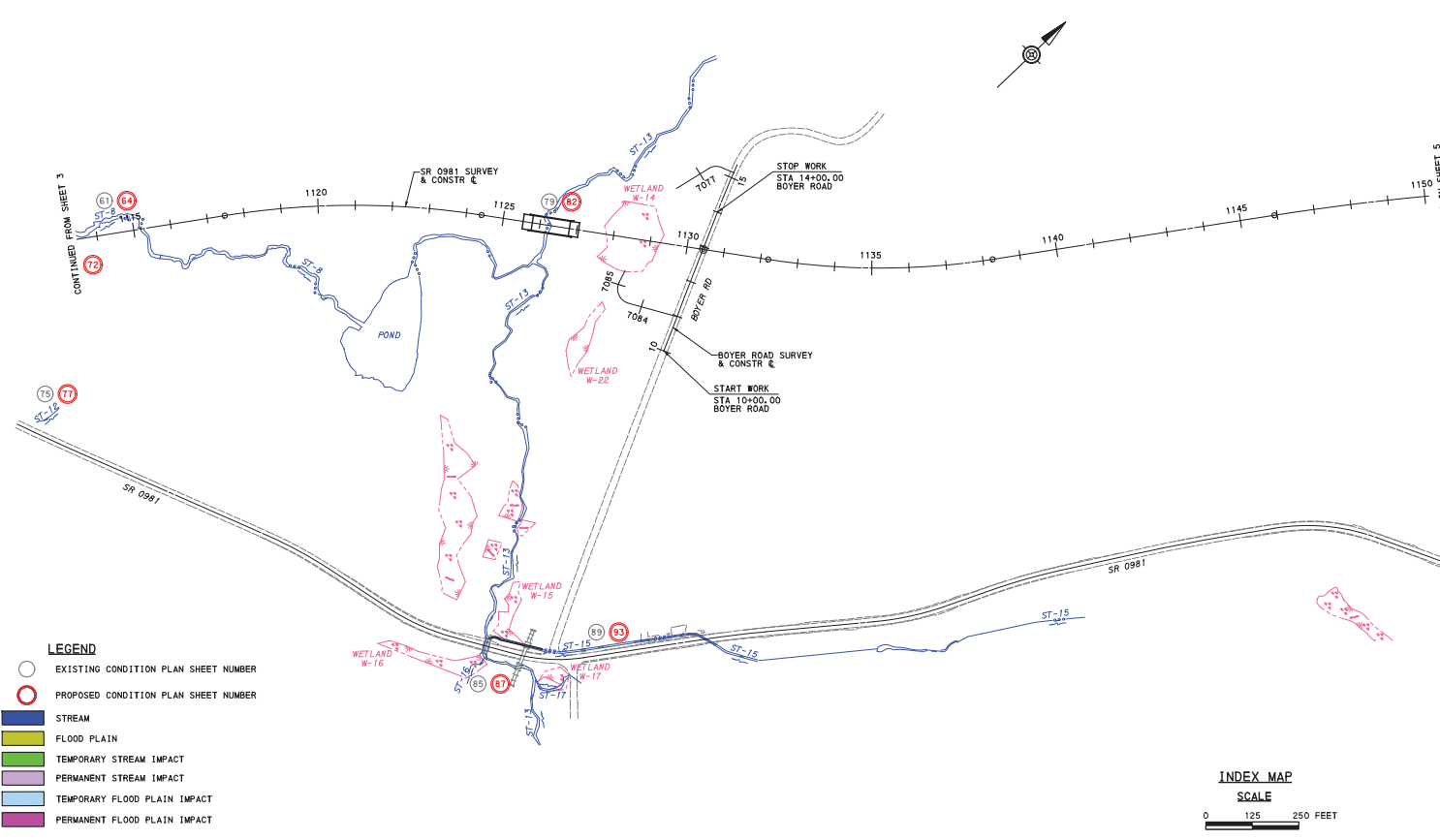

- LEGEND**
- EXISTING CONDITION PLAN SHEET NUMBER
 - PROPOSED CONDITION PLAN SHEET NUMBER
 - STREAM
 - FLOOD PLAIN
 - TEMPORARY STREAM IMPACT
 - PERMANENT STREAM IMPACT
 - TEMPORARY FLOOD PLAIN IMPACT
 - PERMANENT FLOOD PLAIN IMPACT

INDEX MAP
 SCALE
 0 125 250 FEET

CONTINUED FROM SHEET 3

CONTINUED ON SHEET 5

3/30/2020 4:09:15 PM
 \\p051\proj\secta\13193-02_PermDOT12_SRO981-02\300_CADD\AP\loc_Ser\Env\form\mnt\1\Stream_Impact\SR 0981-02\FD005_IN05.dgn

DISTRICT	COUNTY	ROUTE	SECTION	SHEET
12-0	WESTMORELAND	0981	Q20	5 OF 156
MOUNT PLEASANT TOWNSHIP				
REVISION NUMBER	REVISIONS	DATE	BY	

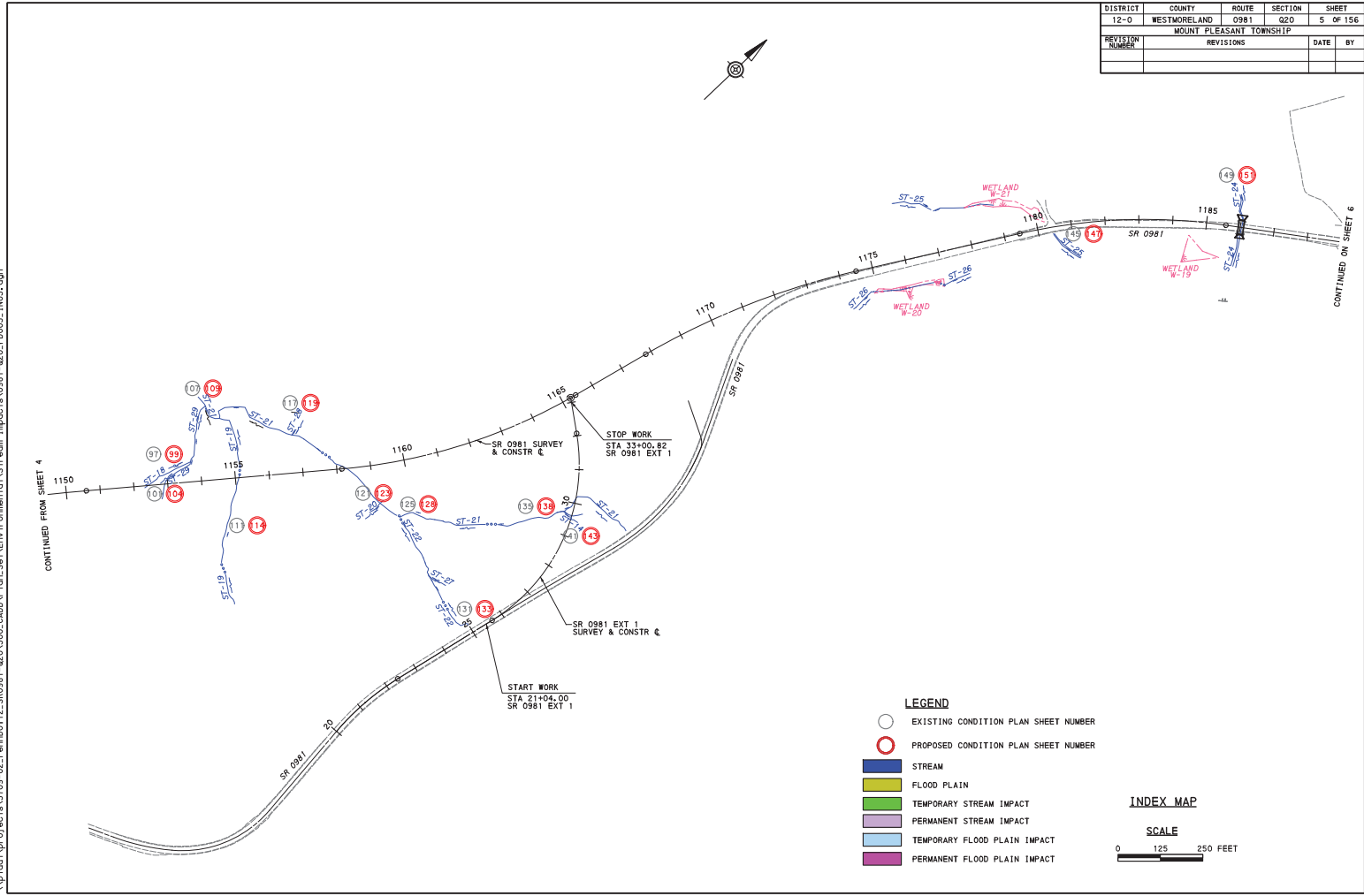

- LEGEND**
- EXISTING CONDITION PLAN SHEET NUMBER
 - PROPOSED CONDITION PLAN SHEET NUMBER
 - ▬ STREAM
 - ▬ FLOOD PLAIN
 - ▬ TEMPORARY STREAM IMPACT
 - ▬ PERMANENT STREAM IMPACT
 - ▬ TEMPORARY FLOOD PLAIN IMPACT
 - ▬ PERMANENT FLOOD PLAIN IMPACT

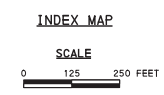

3/30/2020 4:08:15 PM
 \\p051\proj\secta\13193-02-PermiDOT12_SRO981-02\300_CADD\p\loc_Sen\Env\Incoment\1\Stream\Impacts\0981-020-FD006-INDC.dgn

DISTRICT	COUNTY	ROUTE	SECTION	SHEET
12-0	WESTMORELAND	0981	Q20	6 OF 156
MOUNT PLEASANT TOWNSHIP				
REVISION NUMBER	REVISIONS	DATE	BY	

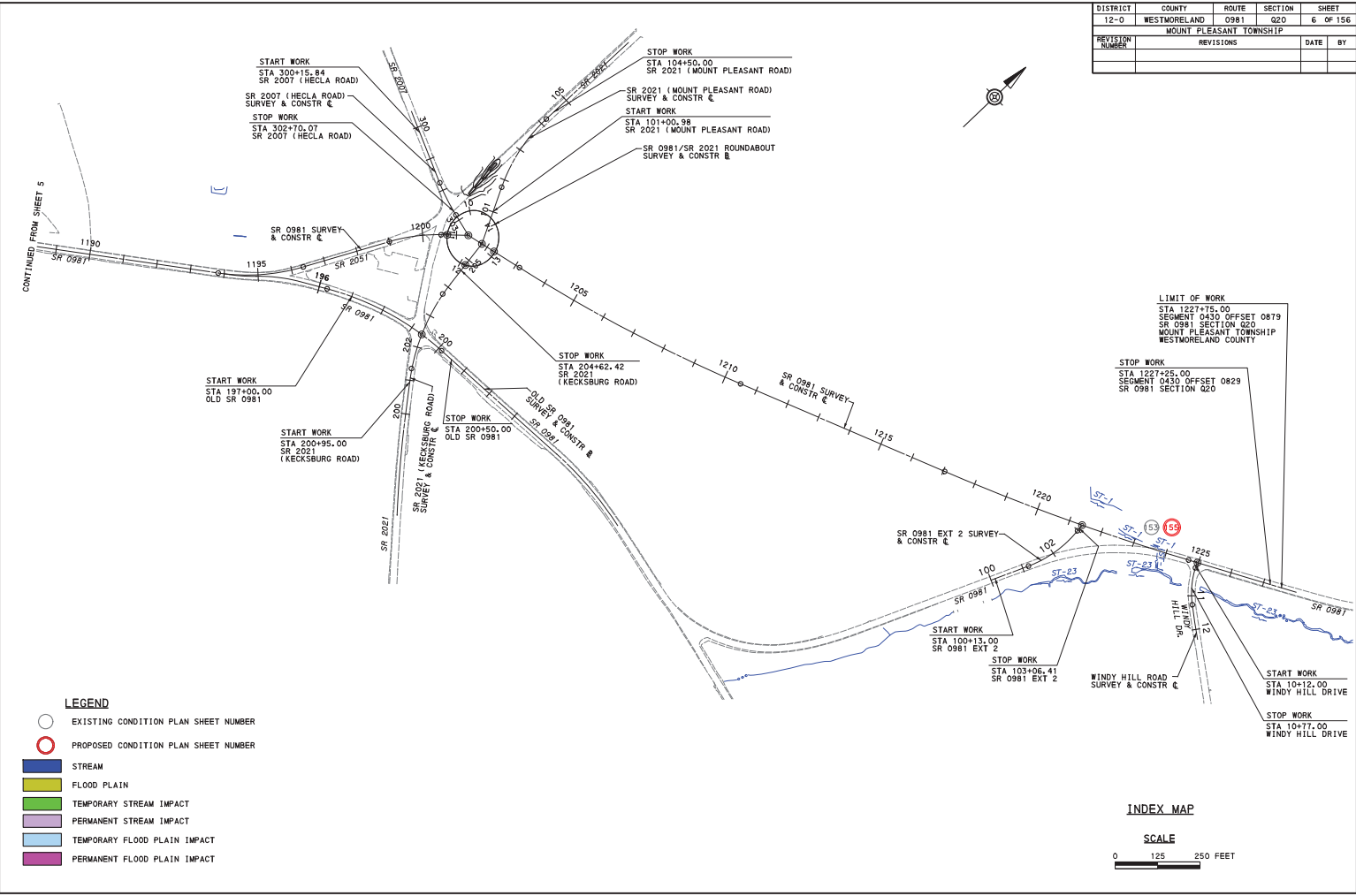

- LEGEND**
- EXISTING CONDITION PLAN SHEET NUMBER
 - PROPOSED CONDITION PLAN SHEET NUMBER
 - STREAM
 - FLOOD PLAIN
 - TEMPORARY STREAM IMPACT
 - PERMANENT STREAM IMPACT
 - TEMPORARY FLOOD PLAIN IMPACT
 - PERMANENT FLOOD PLAIN IMPACT

LIMIT OF WORK
 STA 1227+75.00
 SEGMENT 0430 OFFSET 0879
 SR 0981 SECTION 020
 MOUNT PLEASANT TOWNSHIP
 WESTMORELAND COUNTY

STOP WORK
 STA 1227+25.00
 SEGMENT 0430 OFFSET 0829
 SR 0981 SECTION 020

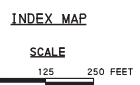

START WORK
 STA 10+12.00
 WINDY HILL DRIVE

STOP WORK
 STA 10+77.00
 WINDY HILL DRIVE

START WORK
 STA 100+13.00
 SR 0981 EXT 2

STOP WORK
 STA 103+06.41
 SR 0981 EXT 2

STOP WORK
 STA 204+62.42
 SR 2021
 (KECKSBURG ROAD)

STOP WORK
 STA 200+50.00
 OLD SR 0981

START WORK
 STA 200+95.00
 SR 2021
 (KECKSBURG ROAD)

START WORK
 STA 197+00.00
 OLD SR 0981

STOP WORK
 STA 104+50.00
 SR 2021 (MOUNT PLEASANT ROAD)

SR 2021 (MOUNT PLEASANT ROAD)
 SURVEY & CONSTR

START WORK
 STA 101+00.00 SR
 SR 2021 (MOUNT PLEASANT ROAD)

SR 0981/SR 2021 ROUNDABOUT
 SURVEY & CONSTR

STOP WORK
 STA 300+15.84
 SR 2007 (HECLA ROAD)

SR 2007 (HECLA ROAD)
 SURVEY & CONSTR

STOP WORK
 STA 302+70.07
 SR 2007 (HECLA ROAD)

SR 0981 SURVEY & CONSTR

SR 2051

SR 0981

SR 2021 (KECKSBURG ROAD)

SR 2021 SURVEY & CONSTR

SR 2021 SURVEY & CONSTR

SR 2021 SURVEY & CONSTR

SR 2021 SURVEY & CONSTR

SR 2021 SURVEY & CONSTR

SR 2021 SURVEY & CONSTR

SR 2021 SURVEY & CONSTR

SR 2021 SURVEY & CONSTR

SR 2021 SURVEY & CONSTR

SR 2021 SURVEY & CONSTR

SR 2021 SURVEY & CONSTR

SR 2021 SURVEY & CONSTR

SR 2021 SURVEY & CONSTR

SR 2021 SURVEY & CONSTR

SR 2021 SURVEY & CONSTR