

LEGEND

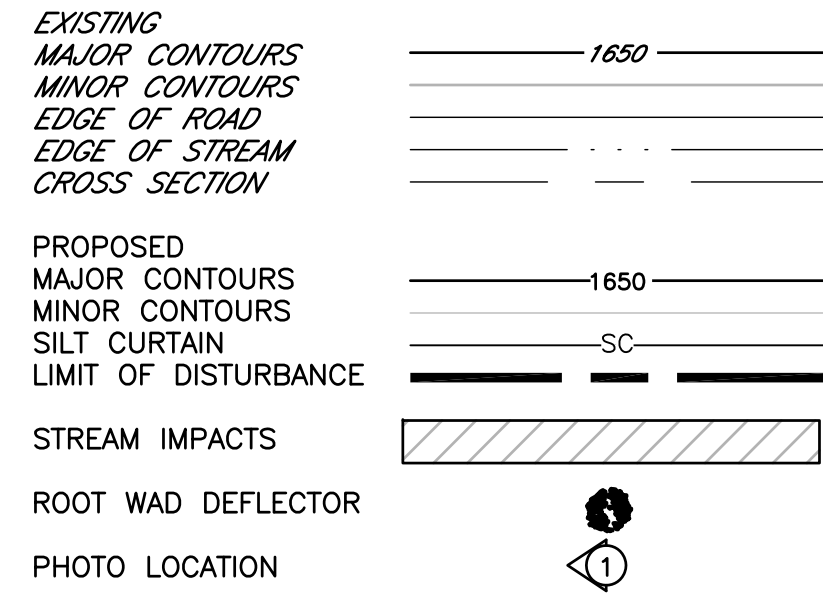

GENERAL NOTES:

- HORIZONTAL CONTROL UTILIZED FOR ALL SURVEY DATA WAS PENNSYLVANIA STATE PLANE COORDINATES, NORTH ZONE IN FEET.
- VERTICAL CONTROL UTILIZE FOR ALL SURVEY DATA WAS NAVD88.
- ALL WORK SHALL BE PERFORMED DURING LOW WATER. IF A FLOOD EVENT IS FORECASTED, CONTRACTOR SHALL STABILIZE THE DISTURBED EMBANKMENT AS NECESSARY.
- ALL RIPRAP MUST BE APPROVED MEETING THE REQUIREMENTS FOUND IN DM 1110-2-2301 "ENGINEERING AND DESIGN - TEST QUARRIES AND TEST FILLS".
- CESSATION OF ACTIVITY FOR AT LEAST 4 CALENDAR DAYS REQUIRES TEMPORARY STABILIZATION.
- THE PROPOSED GRADING AND MODIFICATIONS TO THE LEVEE SYSTEM ARE PART OF PHASE 3 MILL CREEK LEVEE LOWER SEGMENT THAT HAS BEEN PREVIOUSLY PERMITTED UNDER GP11-5314-001 AND WILL BE PERFORMED FOLLOWING THE IMPROVEMENTS OF THE DEBRIS BASIN. SEE PREVIOUS PERMITTED PLANS FOR DETAILS.
- THE PURPOSE OF THIS PLAN IS TO REGRADE THE DEBRIS BASIN TO ASSIST THE BOROUGH IN MAINTENANCE ACCESS.

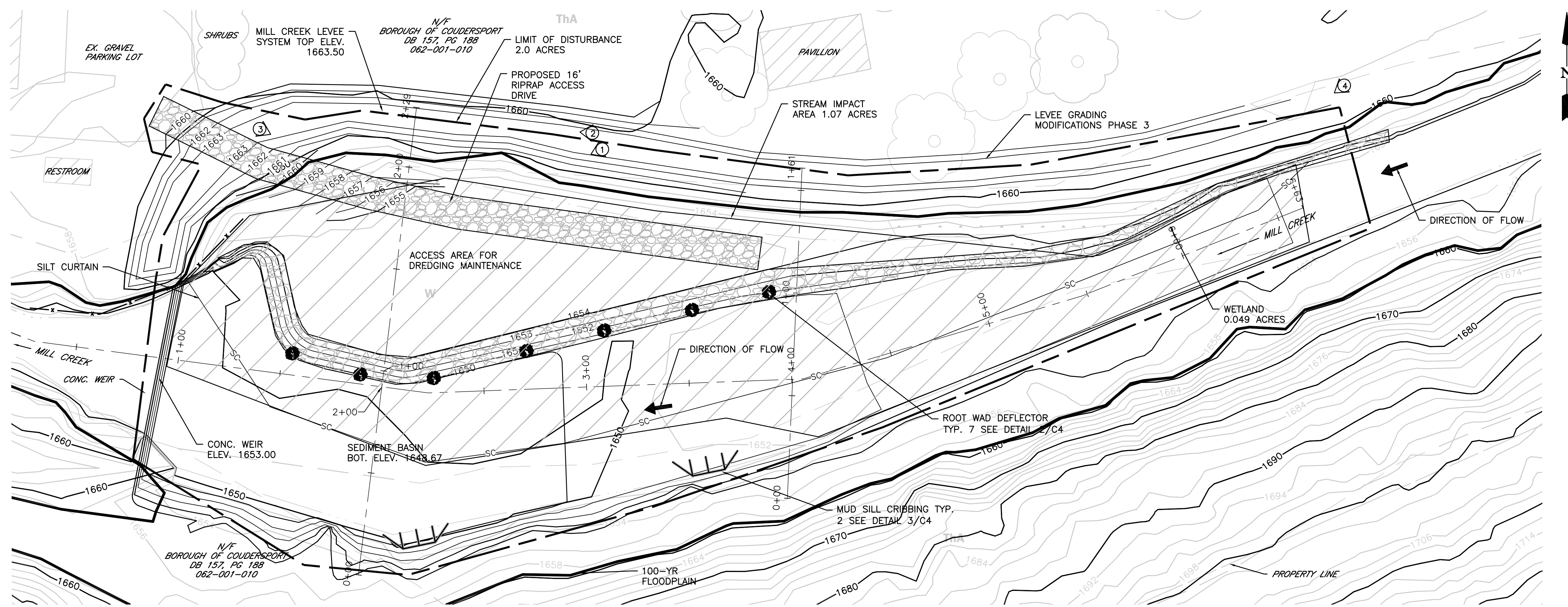

MILL CREEK DEBRIS BASIN

SCALE: 1" = 30'

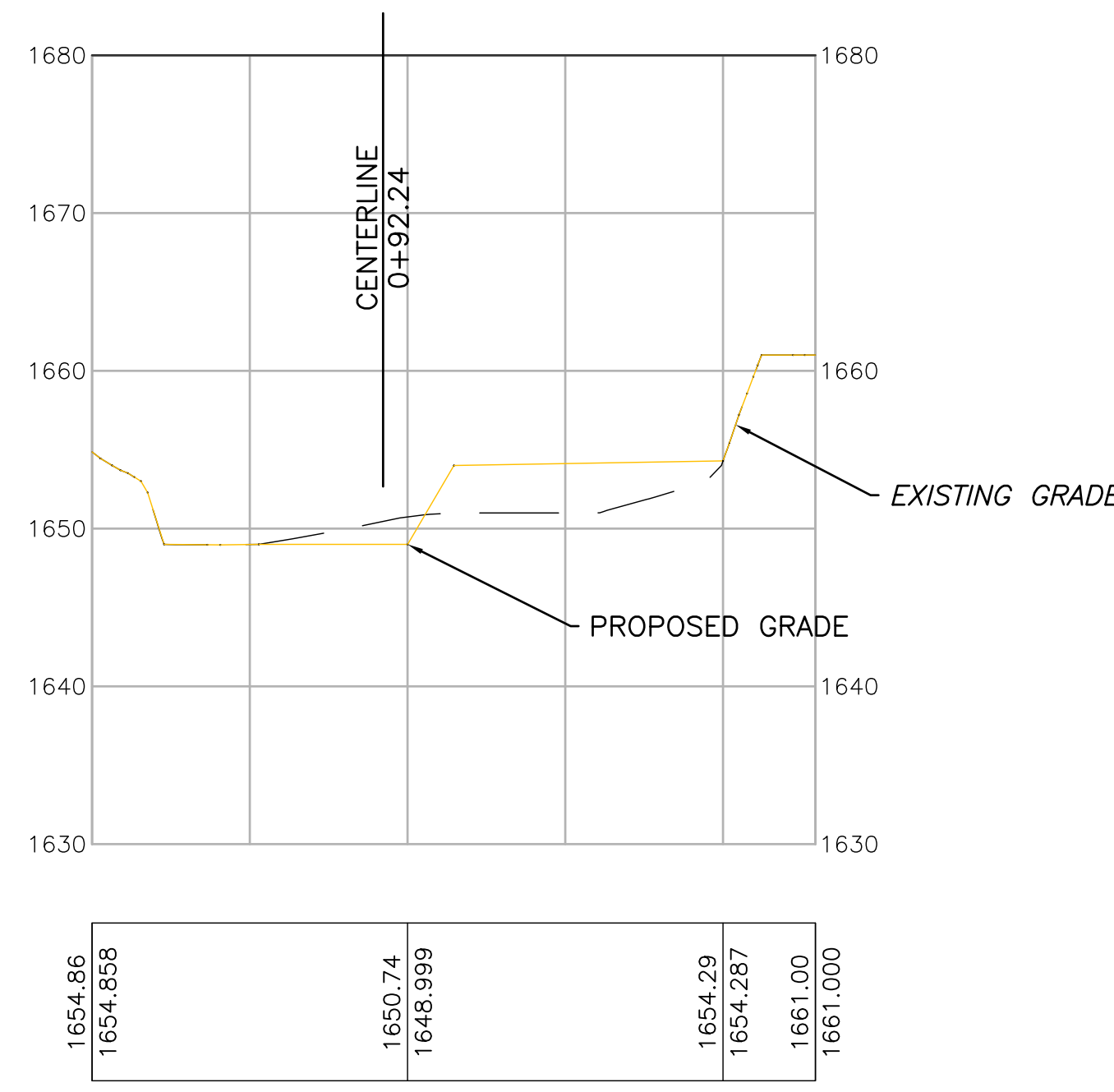
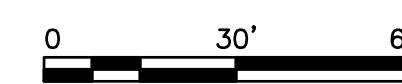

SECTION THROUGH BASIN 2+00

HORZ: 1" = 50'
 VERT. 1" = 10'

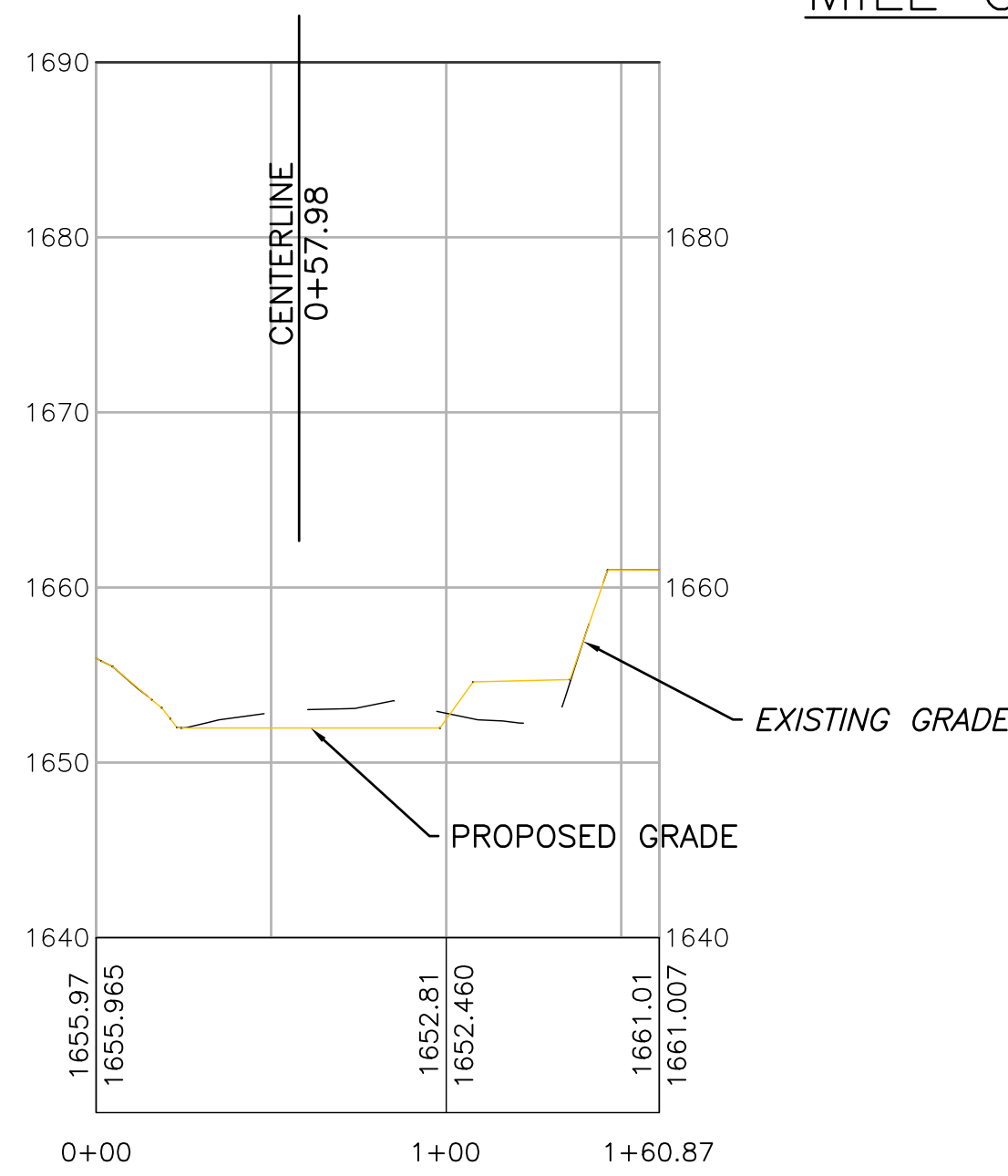

SECTION THROUGH BASIN 4+00

HORZ: 1" = 50'
 VERT. 1" = 10'

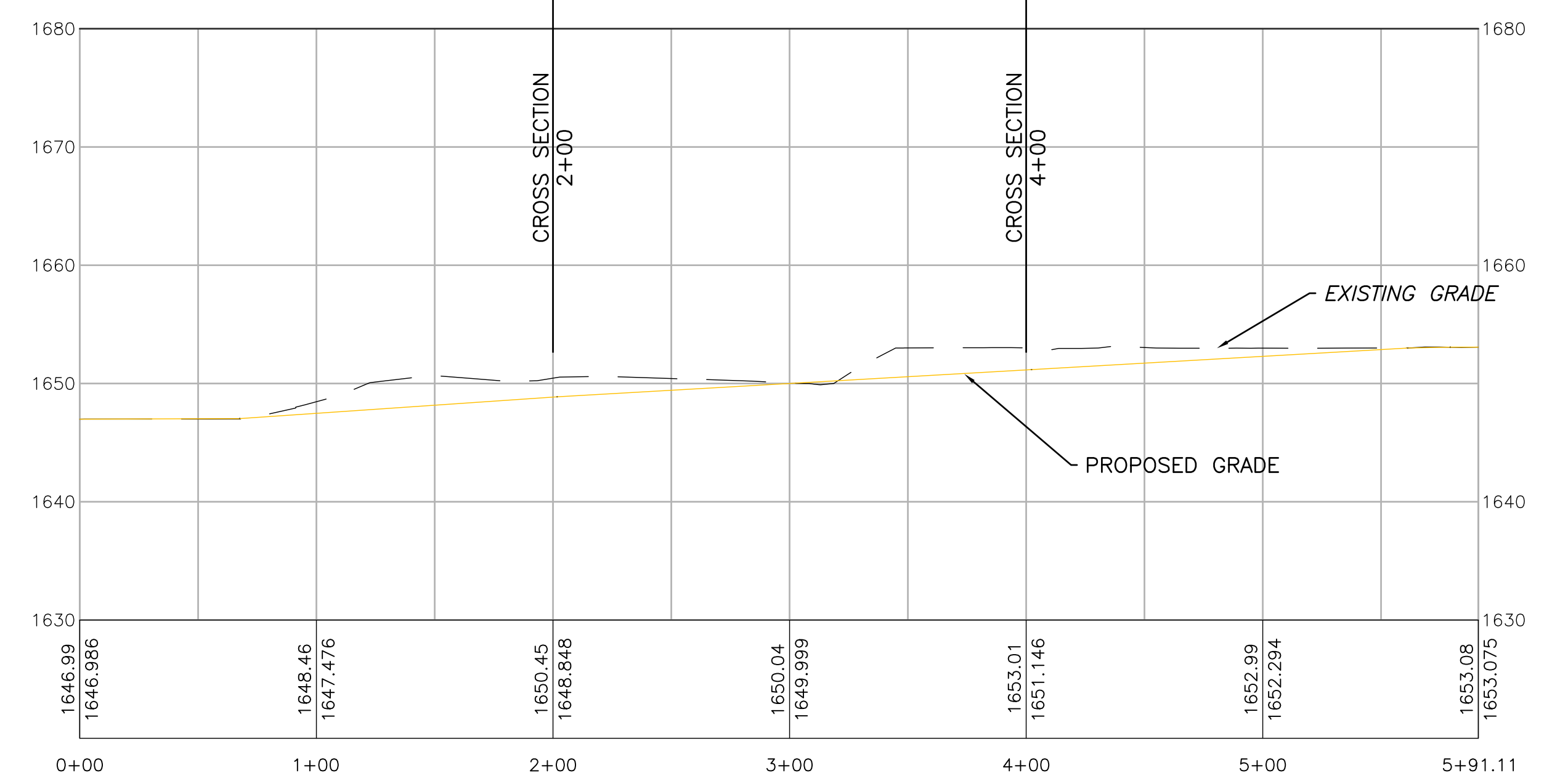

CENTERLINE PROFILE

HORZ: 1" = 50'
 VERT. 1" = 10'

PREPARED FOR:
BOROUGH OF COUDERSPORT
 201 SOUTH WEST STREET
 COUDERSPORT, PA16915

COUDERSPORT BOROUGH MILL CREEK DEBRIS BASIN IMPROVEMENT PROJECT
 COUDERSPORT, PA
 POTTER COUNTY

NO.	REVISION:	DATE:

CES ENGINEERING, LLC
 - WE HAVE THE RIGHT SOLUTION FOR YOU -
 • MECHANICSBURG, PA (717) 574-4345 • HUNTINGDON, PA (814) 644-6621
 7910 Sunrise Camp Road, Huntingdon, PA 16652
 (814) 644-6621
 lzegeer@ces-engr.com

SHEET TITLE: DEBRIS BASIN MODIFICATIONS
 SCALE: 1" = 30' DRAWN: LSZ DATE: 8/10/15
 SHEET NO.: 3 OF: 6
 JOB NO: 13007.01.04

C-3